

Craftsman PermaWrap® - Installation Instructions

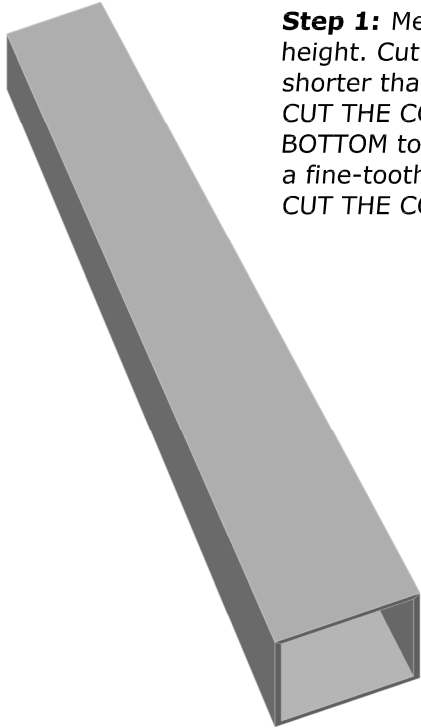

Step 1: Measure the opening height. Cut the column 1/8" shorter than your measurement. **CUT THE COLUMN FROM THE BOTTOM** to the desired length with a fine-tooth carbide blade. **DO NOT CUT THE COLUMN FROM THE TOP!**

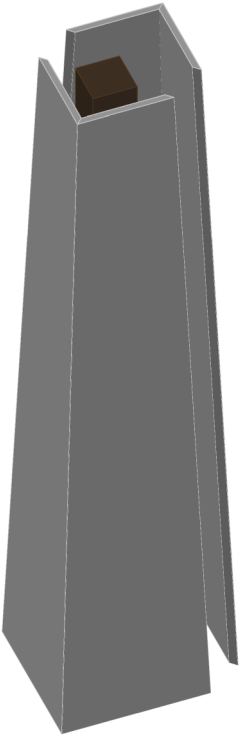

Step 2: Place the L-shaped column half in position around the structural support.

Step 3: Apply a continuous 1/4" bead of urethane adhesive caulk (included) along both mitered edges of the column half.

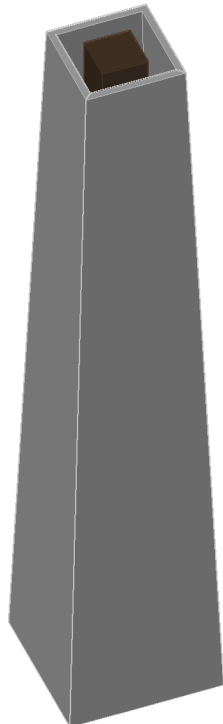

Step 4: Use a pneumatic finish nailer or stapler to fasten the other L half every 6"-8" along both sides of the column wrap. **NOTE: Clean off any caulk squeeze-out with a clean, damp rag.**

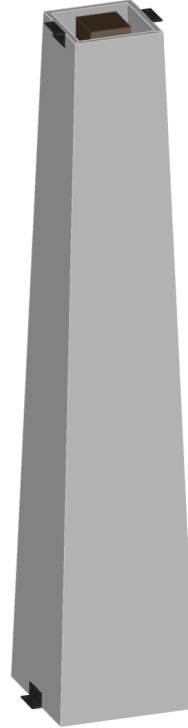

Step 5: Install the 4 mounting brackets. 2 brackets attach to the top of the column to the beam, & 2 attach to the bottom of the column to the substrate. **NOTE: The brackets should be affixed 180° apart.** First, use the blue screws to attach the brackets to the bottom substrate & to the beam resting above. If the floor surface is concrete or masonry, use a 3/16" masonry drill bit to drill the screw attachment holes. Drill the holes at least 2-1/4" deep. Clean debris from holes. Drill 1/8" holes for screws being fastened to the beam. After attaching the brackets to the mounting surfaces, use the silver screws to attach the brackets to the column shaft. Drill 1/8" holes for screws being fastened to the column shaft.

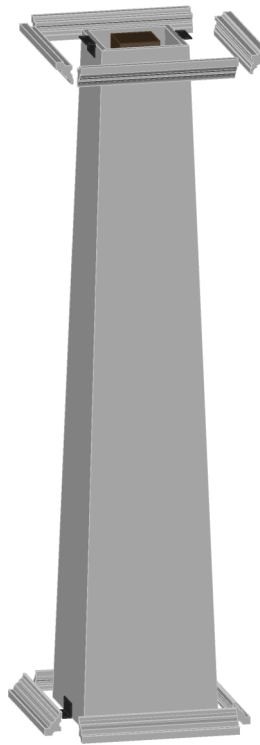

Step 6: Fit the cap and base moulding around the column. Take measurements and trim with a miter saw as necessary. Secure the cap and base moulding with a finish nailer or trim screws.

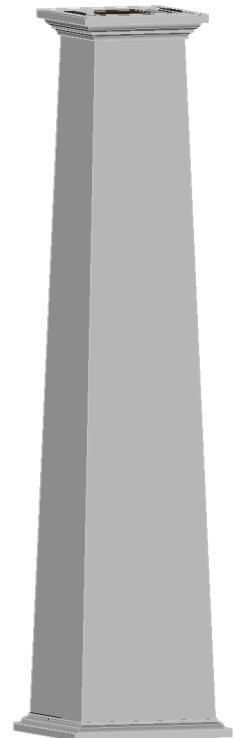

Step 7: If you want to use the included neck moulding, proceed with fit checking & trimming pieces as necessary. Fasten them using a finish nailer or trim screws. **Note: Use galvanized or stainless steel fasteners. Your Column is Complete. Proceed with the finishing/painting instructions.**